

# Stretch Your Imagination

## RMS™ QUEEN'S ARCH DIRECTIONS

updated 6/6/00

Basic Instructions for Loading Balloons in Queen's arch and Supporting Columns made from corrugated plastic RMS™.

Note: It is easier to connect the RMS™ Builder sections to the RMS™ Queen's Arch before loading balloons.

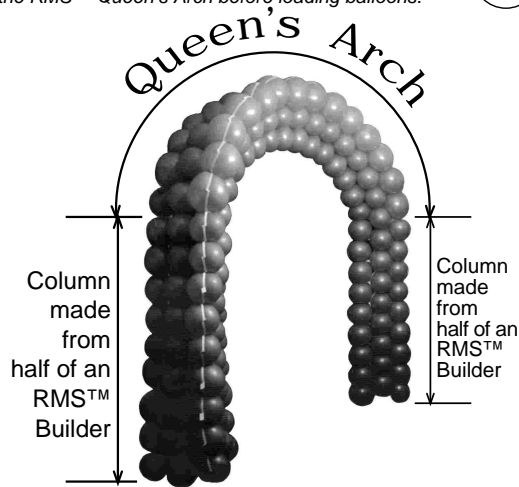

The Matrix comes precoated with adhesive for better balloon grip. You may add additional spray adhesive if you like. (we recommend 3-M brand #77 spray adhesive). If you paint the Matrix, let the paint dry and add adhesive on top of paint.

LOAD DOUBLETS THROUGH CENTER ROW OF MATRIX OPENINGS.

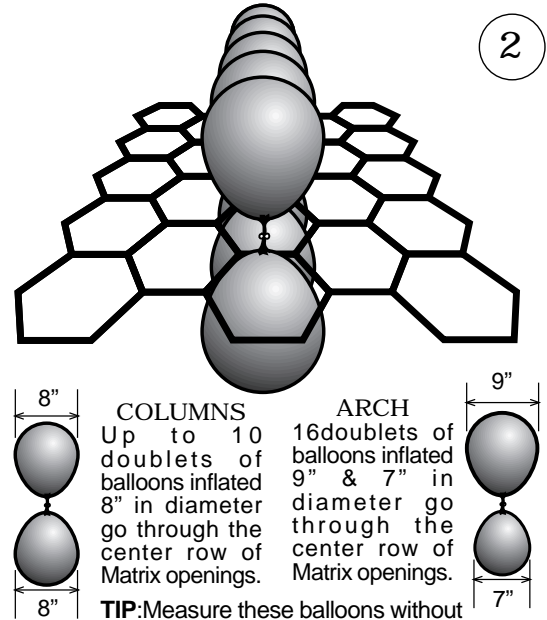

**COLUMNS**  
Up to 10 doublets of balloons inflated 8" in diameter go through the center row of Matrix openings.

**ARCH**  
16 doublets of balloons inflated 9" & 7" in diameter go through the center row of Matrix openings.

**TIP:** Measure these balloons without squeezing them first. Tie balloons together at ends of balloon necks.

FOLD UP SIDE ROWS OF MATRIX & LOAD DOUBLETS ACROSS CENTER ROW OF MATRIX OPENINGS.

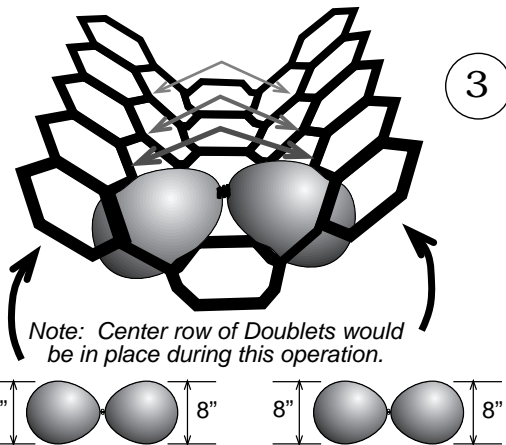

Note: Center row of Doublets would be in place during this operation.

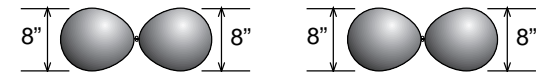

**COLUMNS**  
Up to 10 doublets of balloons inflated 8" in diameter connect openings across the center row.

**ARCH**  
16 doublets of balloons inflated 8" in diameter connect openings across the center row.

**TIP:** Measure these balloons without squeezing them. Tie balloons close together.

LOAD DOUBLETS IN OUTSIDE ROWS OF MATRIX OPENINGS.

Note: These rows of balloons should be squeezed before measuring in templates.

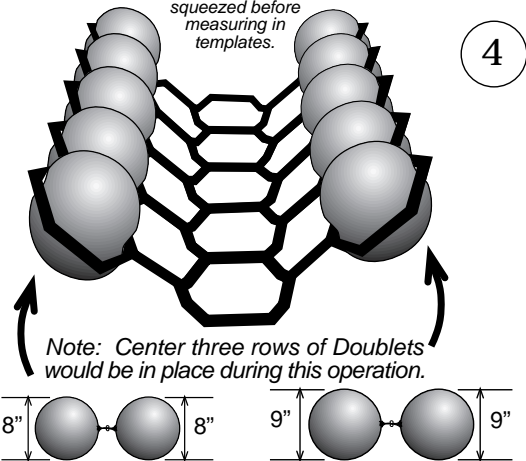

Note: Center three rows of Doublets would be in place during this operation.

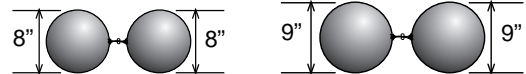

**COLUMNS**  
Up to 10 doublets of balloons inflated 8" in diameter in outside rows.

**ARCH**  
16 doublets of balloons inflated 9" in diameter go in outside rows.

**TIP:** Measure these balloons after squeezing them. Tie balloons together at ends of balloon necks

To connect Queen's Arch to half Builder sections: First, overlap the three tabs on the long sides of the unexpanded Matrix as shown in figure 5. Then, run cable ties through side tabs as in figure 6. Pull tightly to secure the connection.

5

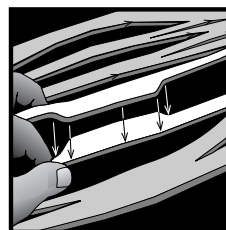

6

